



Woven tote bag

OS

300 GSM

Details

- Top edge double folded for strength and clean finish
- Long handles with reinforced cross stitch
- Shaping seam at bottom to create volume

Composition

Shell - Canvas
 80% Cotton - Recycled , 20% Polyester - Recycled - 300 GSM
 Fabric washed

Care

Wash similar colours together, do not iron on print, wash and iron inside out.



Country of origin

Weaving : Bangladesh
 Dyeing : Bangladesh
 Assembly : Bangladesh



Whites

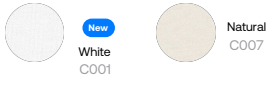

Colors

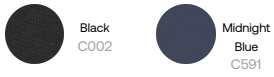

Essential Heathers



Size Guide

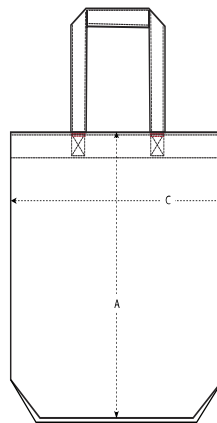

	Sizes	OS
A	Height	39
C	Width	37
D	Strap Length	65

Packing

	Sizes	OS
	Pieces/bag	5
	Pieces/box	100